

**MONA CITY  
ORDINANCE 2022-21**

**NOW THEREFORE**, be it ordained by the Council of the Mona City, in the State of Utah, as follows:

**SECTION 1:**        **AMENDMENT** “11-10-4 SYSTEM EXTENSIONS - SUBDIVISIONS OR PLANNED DEVELOPMENT PROJECT” of the Mona City Code is hereby *amended* as follows:

**BEFORE AMENDMENT**

**11-10-4 SYSTEM EXTENSIONS - SUBDIVISIONS OR PLANNED DEVELOPMENT PROJECT**

- A. Adequate Facilities Required: All subdivisions and planned development projects shall have adequate vehicular access over public streets and shall be served by the city central water distribution system and sewage collection system. The required improvements shall include such improvements as are necessary, in accordance with established level of service standards, for vehicular access and circulation and proper operation of water and sewer utility systems within the boundary of a proposed subdivision or planned development project (on-site facilities) and also those contiguous to the boundary of the proposed project and considered necessary to provide adequate service to the proposed project (off-site facilities). All such facilities shall be designed, approved and constructed in accordance with the applicable provisions of this title, the zoning ordinance and other applicable regulations and standards and specifications adopted pursuant thereto.
- B. Approval of Plans; Concurrent with Development Plan:
  - 1. The City Engineer shall review and approve or disapprove all plans for facilities required for submission for approval of subdivision or planned development projects. The City Engineer may, where necessary to adequately accommodate a proposed project, require amendments to the design of the project plan and, pursuant to the provisions of subsection C. of this section, require the installation of facilities having capacities in excess of the minimum required to serve the proposed development.
  - 2. For purposes of compliance with the provisions of this section, the review of the proposed extensions shall be conducted concurrently with, and as part of, the review process for the applicable subdivision or planned development project.
- C. Oversize Facilities may be Required: Where identified in the general plan or where the City Council has determined that future growth of the city necessitates the construction of streets or water or sewer mains having a capacity larger than required to serve the proposed development, the construction of such oversize line or facility shall be

required as a condition of approval of the extension. Costs for the construction of the oversize portion of the project shall be borne by the city or be incorporated within the terms of reimbursement agreements, as determined applicable.

## AFTER AMENDMENT

### 11-10-4 SYSTEM EXTENSIONS - SUBDIVISIONS OR PLANNED DEVELOPMENT PROJECT

- A. Adequate Facilities Required: All subdivisions and planned development projects shall have adequate vehicular access over public streets and shall be served by the city central water distribution system and sewage collection system. The required improvements shall include such improvements as are necessary, in accordance with established level of service standards, for vehicular access and circulation and proper operation of water and sewer utility systems within the boundary of a proposed subdivision or planned development project (on-site facilities) and also those contiguous to the boundary of the proposed project and considered necessary to provide adequate service to the proposed project (off-site facilities). All such facilities shall be designed, approved and constructed in accordance with the applicable provisions of this title, the zoning ordinance and other applicable regulations and standards and specifications adopted pursuant thereto.
- B. Approval of Plans; Concurrent with Development Plan:
1. The City Engineer shall review and approve or disapprove all plans for facilities required for submission for approval of subdivision or planned development projects. The City Engineer may, where necessary to adequately accommodate a proposed project, require amendments to the design of the project plan and, pursuant to the provisions of subsection C. of this section, require the installation of facilities having capacities in excess of the minimum required to serve the proposed development.
  2. For purposes of compliance with the provisions of this section, the review of the proposed extensions shall be conducted concurrently with, and as part of, the review process for the applicable subdivision or planned development project.
- C. Oversize Facilities may be Required: Where identified in the general plan or where the City Council has determined that future growth of the city necessitates the construction of streets or water or sewer mains having a capacity larger than required to serve the proposed development, the construction of such oversize line or facility shall be required as a condition of approval of the extension. Costs for the construction of the oversize portion of the project shall be borne by the city or be incorporated within the terms of reimbursement agreements, as determined applicable.

D.

#### Requirements

PASSED AND ADOPTED BY THE MONA CITY COUNCIL

---

	<b>AYE</b>	<b>NAY</b>	<b>ABSENT</b>	<b>ABSTAIN</b>
Councilmember Jay Christensen	_____	_____	_____	_____
Councilmember Amy Stanley	_____	_____	_____	_____
Councilmember Ron Warren	_____	_____	_____	_____
Councilmember Jay Mecham	_____	_____	_____	_____
Councilmember TJ Pace	_____	_____	_____	_____

Presiding Officer

Attest

---

Randy Christensen, Mayor, Mona  
City

---

Alicia Hills, Recorder Mona City

**EXHIBIT A**

**The file attached hereto as Exhibit "A" is hereby added and incorporated herein by this reference**

**EXHIBIT B**

**The file attached hereto as Exhibit "B" is hereby added and incorporated herein by this reference**

- NOTE:
1. WHENEVER POSSIBLE, CULINARY WATER LINES SHALL BE INSTALLED ON THE NORTH AND EAST SIDE OF THE STREET.
  2. FIRE HYDRANTS SHALL BE LOCATED EVERY 1000 FEET AND ON THE SAME SIDE AS THE CULINARY WATER LINES OR AS APPROVED BY THE CITY.
  3. WATER VALVES SHALL BE PLACED IN THE ASPHALT WITH A MIN. 6" WIDE X 4" THICK CONCRETE RING.
  4. NO CULINARY WATER LINE SMALLER THAN 8" DIA. SHALL BE INSTALLED WITHOUT APPROVAL OF MONA CITY.
  5. NO PRESSURE IRRIGATION LINE SMALLER THAN 6" DIA. SHALL BE INSTALLED WITHOUT APPROVAL OF AFFECTED IRRIGATION ENTITY.
  6. IMPORTED GRANULAR MATERIAL, ROAD BASE AND ASPHALT SHALL MEET REQUIRED THICKNESS AS DETERMINED BY MONA CITY.
  7. REQUIRED COVER OVER UTILITY LINES ARE AS FOLLOWS:  
 CULINARY WATER - 48" MINIMUM  
 PRESSURE IRRIGATION - 24" MINIMUM  
 ALL OTHERS - PER UTILITY REQUIREMENTS
  8. ALL CONSTRUCTION TO BE PERFORMED BY LICENSED AND INSURED CONTRACTORS.
  9. ASPHALT TO BE ¾" HOT MIX.
  10. UTILITY COMPANIES TO OBTAIN A DIGGING PERMIT FROM THE MONA CITY OFFICES.

66' STREET CROSS-SECTION

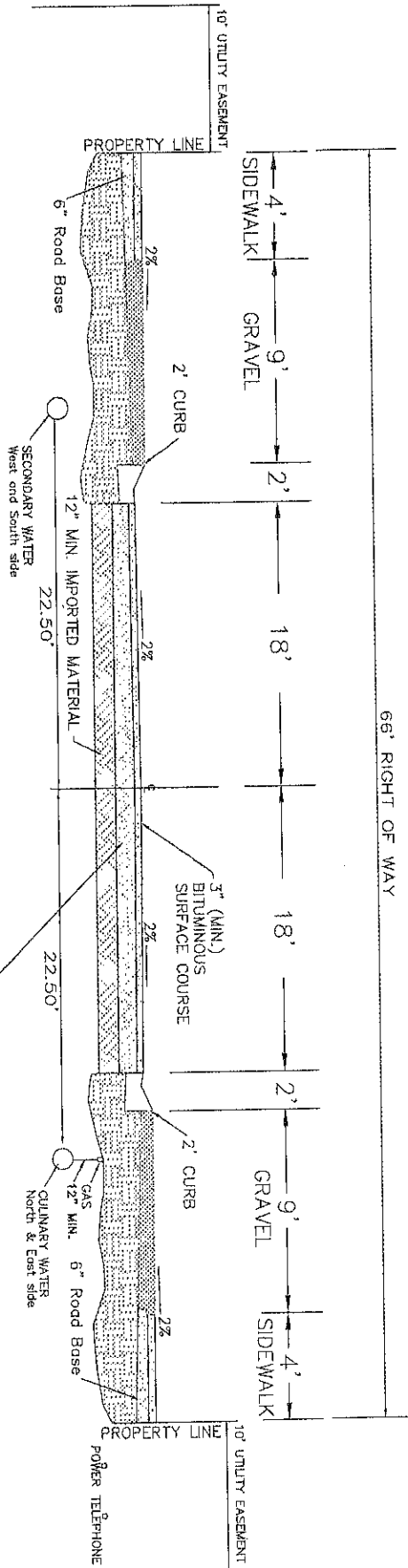

AGGREGATE BASE SPECIFICATION  
 PASSING 1-INCH SIEVE = 100%  
 PASSING ¾-INCH SIEVE = 85% - 100%  
 PASSING No. 4 SIEVE = 45% - 65%  
 PASSING No. 10 SIEVE = 30% - 50%  
 PASSING No. 200 SIEVE = 5% - 10%

6" MIN. AGGREGATE BASE  
 OR AS DIRECTED BY MONA CITY  
 AT THE TIME OF SOIL DETERMINATION.

ALL FILL MATERIAL LAYERS SHALL NOT HAVE OVER EIGHT INCHES OF LOOSE MATERIAL.  
 COMPACTION WILL HAVE OPTIMUM MOISTURE TO INSURE COMPACTION OF 95% OR HIGHER.  
 COMPACTOR TEST RESULTS APPROVED BY SUPERVISOR OF STREETS.  
 DEVELOPER PAYS FOR ALL SOIL AND COMPACTION TESTING.

STATEMENT OF USE  
 THIS DOCUMENT AND ANY ILLUSTRATIONS HEREON ARE PROVIDED AS STANDARD  
 CONSTRUCTION DETAILS WITHIN MONA CITY. DEVIATION FROM THIS DOCUMENT  
 REQUIRES APPROVAL OF MONA CITY. MONA CITY CORPORATION  
 CAN NOT BE HELD LIABLE FOR MISUSE OR CHANGES REGARDING THIS DOCUMENT.

PLANNING & ZONING APPROVAL \_\_\_\_\_  
 ADOPTED DATE: \_\_\_\_\_

REVISION			STANDARD STREET CROSS SECTIONS AND UTILITY LOCATIONS  MONA CITY 50 WEST CENTER STREET	STANDARD DRAWING NUMBER: CAB DWS: MONA STANDARDS#1
BY	DATE			



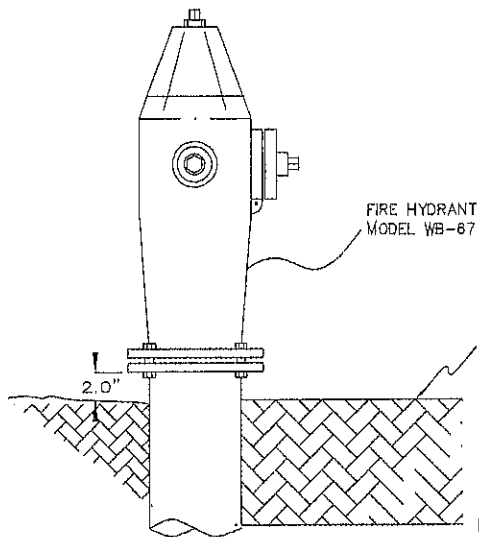

FIRE HYDRANT  
MODEL WB-87

FINISH GRADE

2.0"

NOTE:  
ALL BOLTS SHALL BE FREE  
FROM CONCRETE AND  
FULLY ACCESSIBLE

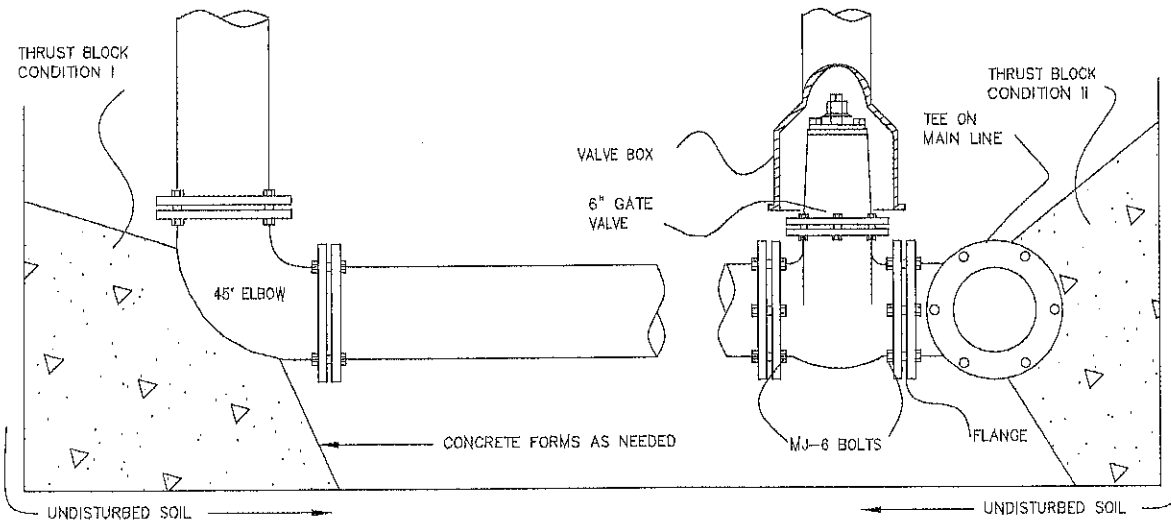

THRUST BLOCK  
CONDITION I

45° ELBOW

CONCRETE FORMS AS NEEDED

UNDISTURBED SOIL

VALVE BOX

6" GATE  
VALVE

MJ-6 BOLTS

THRUST BLOCK  
CONDITION II

TEE ON  
MAIN LINE

FLANGE

UNDISTURBED SOIL

NOTES:

1. ALL THRUST BLOCKS TO BE FORMED AND APPROVED BY MONA CITY BEFORE POURING CONCRETE.
2. MEGALUGS TO BE USED ON ALL THRUST CONNECTIONS.

PLANNING & ZONING APPROVAL

STATEMENT OF USE

THIS DOCUMENT AND ANY ILLUSTRATIONS HEREON ARE PROVIDED AS STANDARD CONSTRUCTION DETAILS WITHIN MONA CITY. DEVIATION FROM THIS DOCUMENT REQUIRES APPROVAL OF MONA CITY. MONA CITY CORPORATION CAN NOT BE HELD LIABLE FOR MISUSE OR CHANGES REGARDING THIS DOCUMENT.

ADOPTED DATE: \_\_\_\_\_

REVISION	DATE	BY	APP	DATE

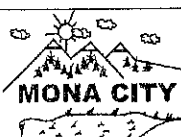

FIRE HYDRANT & WATER VALVE DETAIL

MONA CITY  
50 WEST CENTER STREET

STANDARD  
DRAWING  
NUMBER:  
CAD DIV. MONA STANDARDS

3



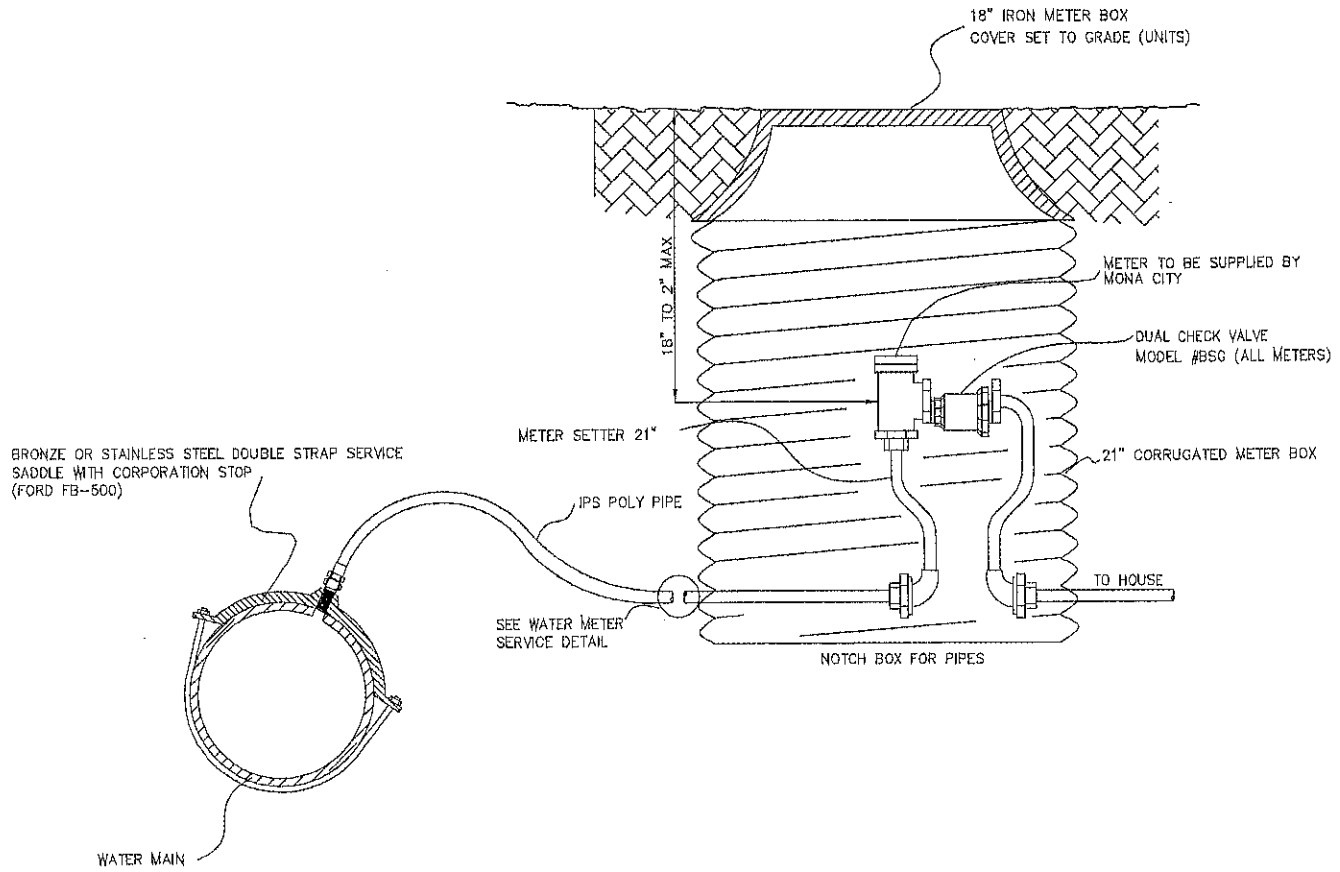

- NOTE:
1. METER BOX AND SETTER INSTALLED BY DEVELOPER/CONTRACTOR.
  2. WATER SERVICE TO BE STUBBED AT CENTER OF LOT.
  3. ALL CONNECTIONS SHALL BE MADE USING PACK JOINTS (COMPRESSION) TYPE FITTINGS.

MONIA CITY CORPORATION WATER SERVICE INFORMATION					
SERVICE SIZE	METER BOX SIZE	TYPE OF MATERIAL FOR METER BOX	WATER METER	CONNECTION TYPE	BYPASS
1"	21" DIA.	CORRUGATED	BY CITY	COMPRESSION	NO

STATEMENT OF USE

THIS DOCUMENT AND ANY ILLUSTRATIONS HEREON ARE PROVIDED AS STANDARD CONSTRUCTION DETAILS WITHIN MONIA CITY. DEVIATION FROM THIS DOCUMENT REQUIRES APPROVAL OF MONIA CITY. MONIA CITY CORPORATION CAN NOT BE HELD LIABLE FOR MISUSE OR CHANGES REGARDING THIS DOCUMENT.

REVISION

NO.	BY	APR.	DATE

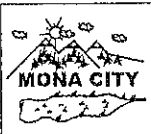

TYPICAL CULINARY WATER CONNECTION

MONIA CITY  
50 WEST CENTER STREET

STANDARD DRAWING NUMBER: CAD DWS-MONIA-STANDARD-055	5
PLANT SCALE:	
ADOPTED DATE:	

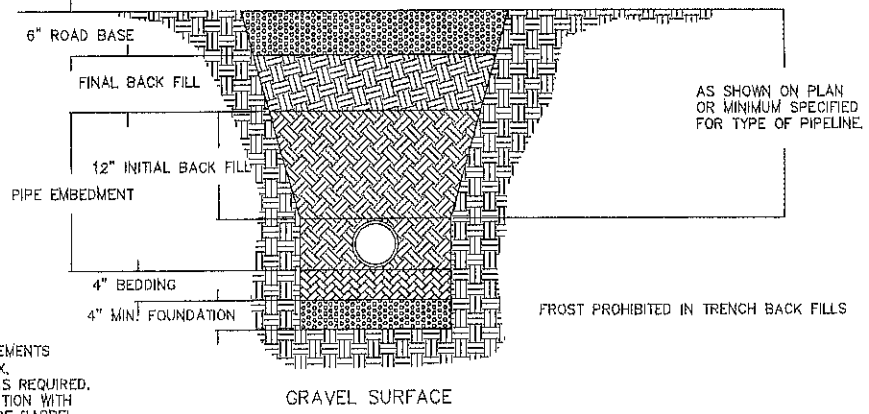
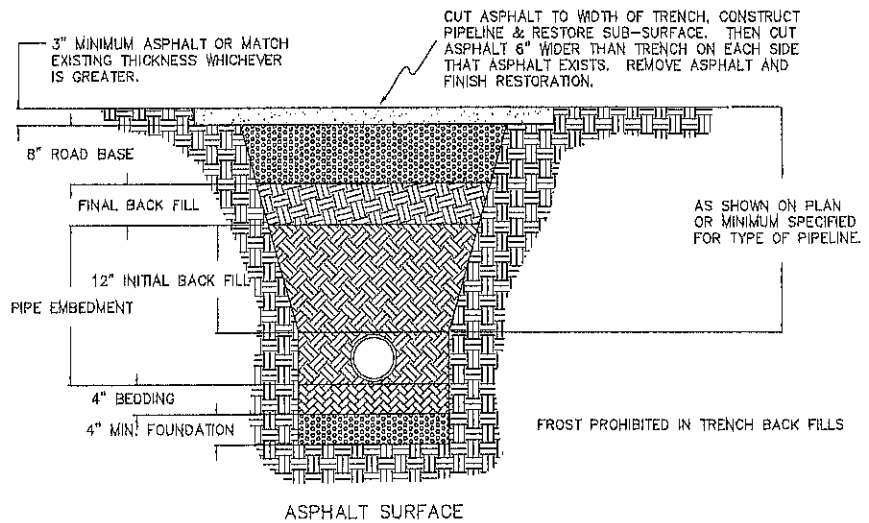

- NOTE:
1. SLOPE TRENCH TO MEET OSHA REQUIREMENTS (LATEST EDITION) OR USE TRENCH BOX.
  2. FOUNDATION AND BEDDING MATERIAL AS REQUIRED.
  3. INSTALL PIPELINES ON STABLE FOUNDATION WITH UNIFORM BEARING FOR FULL LENGTH OF BARREL. EXCAVATE IN BEDDING FOR ALL PIPE JOINTS.

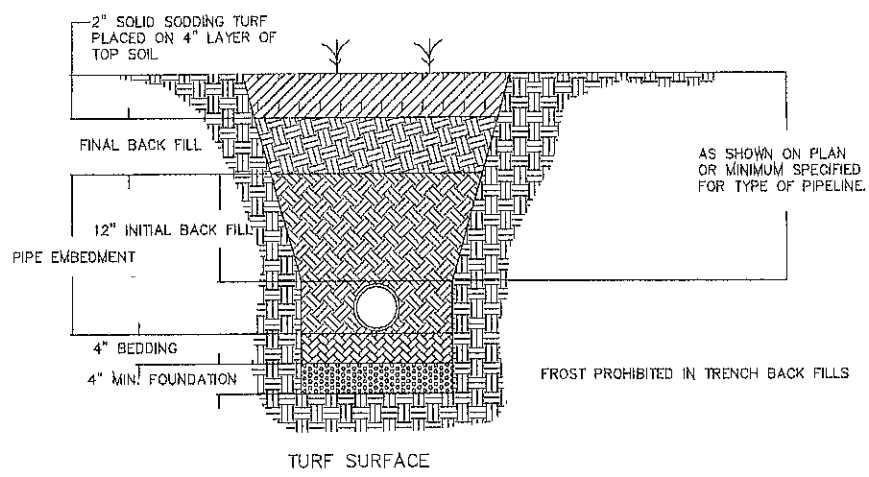

STATEMENT OF USE

THIS DOCUMENT AND ANY ILLUSTRATIONS HEREON ARE PROVIDED AS STANDARD CONSTRUCTION DETAILS WITHIN MONA CITY. DEVIATION FROM THIS DOCUMENT REQUIRES APPROVAL OF MONA CITY. MONA CITY CORPORATION CAN NOT BE HELD LIABLE FOR MISUSE OR CHANGES REGARDING THIS DOCUMENT.

PLANNING & ZONING APPROVAL

ADOPTED DATE: \_\_\_\_\_

REVISION	DATE	BY	APP	CITY

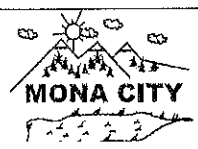

TYPICAL TRENCH SECTIONS

MONA CITY

50 WEST CENTER STREET

STANDARD DRAWING NUMBER: 3  
 CAD DWG: MONA STANDARD01

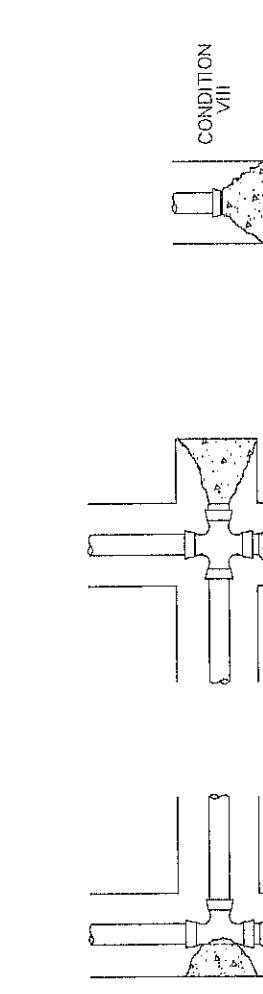
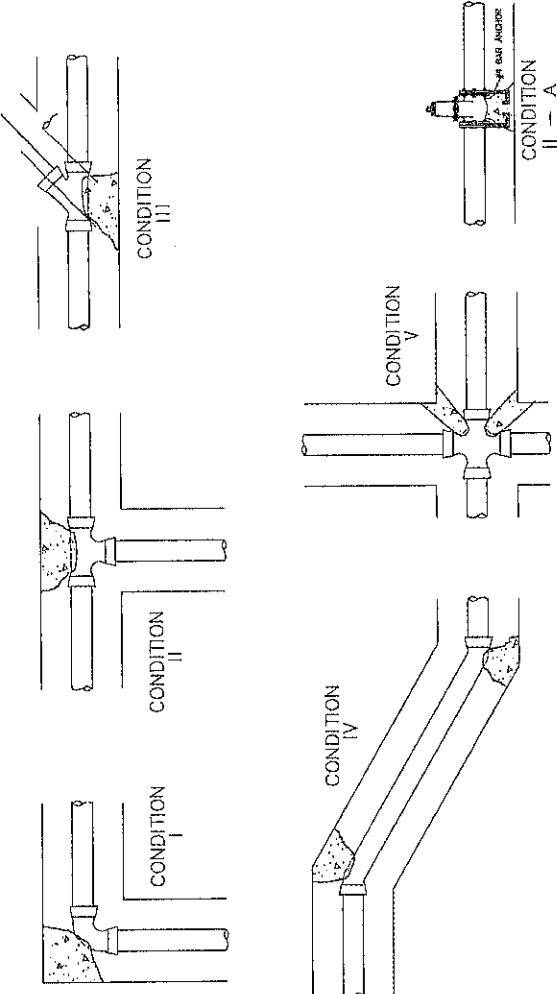

- NOTES:
1. ALL THRUST BLOCK BEARING FACES SHALL BE SQUARED AGAINST UNDISTURBED SOIL OR APPROVED COMPACTED BACKFILL.
  2. CONCRETE SHALL BE CLASS 864-C-3000.
  3. THRUST BLOCKS SHALL NOT INTERFERE WITH ACCESS TO THE JOINT.
  4. ALL BOLTS ON MECHANICAL JOINT FITTINGS SHALL BE FREE FROM CONCRETE AND FULLY ACCESSIBLE.
  5. CONCRETE FORMS TO BE USED AROUND THRUST BLOCKS TO PROTECT BOLTS AND INCREASE EFFECTIVENESS.

THRUST BLOCK BEARING AREA IN SQUARE FEET

PIPE SIZE	CONDITION I	CONDITION II	CONDITION III	CONDITION IV	CONDITION V	CONDITION VI	CONDITION VII	CONDITION VIII
4	3.3	2.6	2.6	1.3	1.3	2.0	3.5	2.9
6	6.5	4.6	3.9	2.0	2.6	3.5	6.5	4.9
8	11.0	7.8	5.9	3.3	3.9	5.9	11.0	7.8
10	17.5	12.4	9.8	5.2	6.5	9.1	17.5	12.4
12	24.8	17.5	13.6	7.9	9.1	12.3	24.8	17.5
14	32.8	24.0	18.2	9.7	12.3	16.9	32.8	24.0
16	44.0	31.1	23.8	12.7	15.6	23.2	44.0	31.1

SCALE: SEE PLANS

THESE PLANS AND SPECIFICATIONS ARE PROVIDED AS GENERAL INFORMATION DETAILS WITH MONA CITY. MONA CITY WILL BE RESPONSIBLE FOR THE DESIGN AND CONSTRUCTION OF THIS PROJECT. MONA CITY COOPERATION CAN NOT BE HELD LIABLE FOR LOSS OR DAMAGE INCURRED BY THE CONTRACTOR.

DESIGNED BY: *[Signature]*

CHECKED BY: *[Signature]*

DATE: \_\_\_\_\_

PROJECT: \_\_\_\_\_

LOCATION: \_\_\_\_\_

MONA CITY  
50 WEST CENTER STREET

THRUST BLOCK DETAILS

4